

30 Percent Design Pole Creek - Road 6305-111

Project Number XX-XXX

DRAWING INDEX:

1. Cover Sheet
2. Legend and Notes
3. Existing Site Plan
4. Site Plan Proposed
5. Road Profiles
6. Stream Profiles
7. Sections and Details
8. Culvert Details

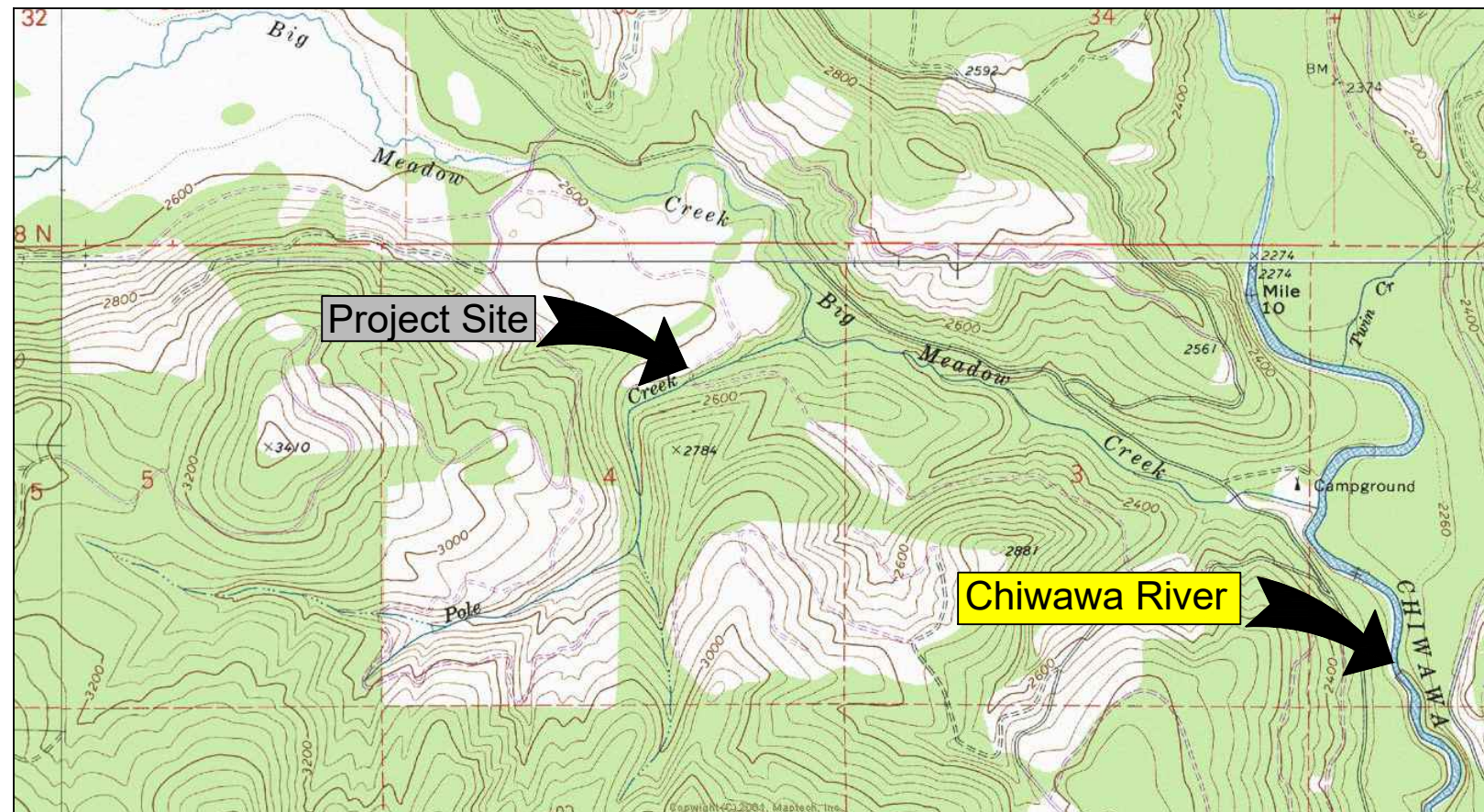

VICINITY MAP
NOT TO SCALE



Pole Creek

Landowner: US Forest Service
 Sec Twship Range: Section 4, T27N, R17E
 Lat and Long: 47 Deg 52' 15.84"N, 120 Deg 43' 19.11" W



REV	DATE	BY	APPD	DESCRIPTION

SCALE VERIFICATION
 BAR IS ONE INCH ON ORIGINAL DRAWING. 0 1"
 IF NOT ONE INCH ON THIS SHEET, ADJUST SCALES ACCORDINGLY.

DESIGN BY:
Waterfall Engineering

DRAWN BY:

DATE:
9/27/22

Cover Sheet

1 8
SHEET OF

SHEET SYMBOLS

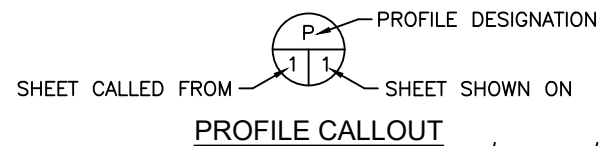
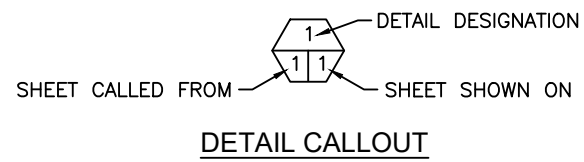

References to Right and Left
as viewed downstream

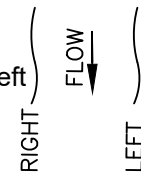

- " - INCHES
- ' - FEET
- APPROX. - APPROXIMATELY
- B&B - BALLED AND BURLAPPED
- BM - BENCH MARK
- CL - CENTERLINE
- CAL. - CALIPER
- CFS - CUBIC FEET PER SECOND
- CLR. - CLEARANCE
- CMP - CORRUGATED METAL PIPE
- CONC. - CONCRETE
- DIA. - DIAMETER
- ELEV. - ELEVATION
- EQ. - EQUAL
- FTG. - FOOTING
- HDPE - HIGH DENSITY POLYETHYLENE
- HT. - HEIGHT
- GAL. - GALLON
- I.D. - INSIDE DIAMETER
- I.E. - INVERT ELEVATION
- LBS. - POUNDS
- LWD - LARGE WOODY DEBRIS
- MAX. - MAXIMUM
- MFG. - MANUFACTURER'S
- MHW - MEAN HIGH WATER
- MHHW - MEAN HIGHER HIGH WATER
- MIN. - MINIMUM
- MISC. - MISCELLANEOUS

ABBREVIATIONS

- MISC. - MISCELLANEOUS
- MPH - MILES PER HOUR
- O.C. - ON CENTER
- O.D. - OUTSIDE DIAMETER
- OHW - ORDINARY HIGH WATER
- PK - PARKER-KALON
- R.O.W. - RIGHT OF WAY
- REQ'D - REQUIRED
- SEC. - SECTION
- S.F. - SQUARE FEET
- SHT. - SHEET
- SPEC'S. - PROJECT SPECIFICATIONS
- STA. - STATION
- SS - STAINLESS STEEL
- TEMP. - TEMPORARY
- TYP. - TYPICAL
- W.S. - WATER SURFACE
- WSDOT - WASHINGTON STATE DEPARTMENT OF TRANSPORTATION
- WSEL - WATER SURFACE ELEVATION

LEGEND

- PROPERTY LINE
- RIGHT OF WAY LINE
- CENTERLINE
- EXISTING FENCE
- BUILDING LINE
- INDEX CONTOUR LINE
- UNDERGROUND POWER
- EXISTING WATER LINE
- EXISTING CALLOUT*
- NEW CALLOUT
- SURVEY POINT
- EXISTING TREES TO REMAIN
- PROJECT BENCH MARK
- BORING LOCATIONS
- SANDBAGS
- NOTE CALLOUT
- STATION CALLOUT
- PHOTO CALLOUT
- ELEVATION MARKER
- TREE TO BE REMOVED
- TREE TO REMAIN
- FOUND SURVEY MONUMENT
- SET CONTROL POINT
- POWER POLE
- MANHOLE
- UTILITY CABINET
- LIGHT POST
- TREE
- WATER VALVE
- OWNERSHIP REFERENCE
- PAVEMENT
- CONCRETE
- FILL
- ROCK/GRAVEL
- UNDISTURBED GRADE
- WETLAND DELINEATION
- DEMO

Survey is Based on Assumed Coordinates Completed
by Waterfall Engineering

Control Points

POINT	EASTING	NORTHING	ELEV	Description
17	1667742.77	317748.22	2534.02	MNHT
18	1667748.95	317816.36	2534.84	MNHT
24	1667698.37	317706.72	2519.41	MNHT
25	1667829.85	317762.88	2513.51	MNHT



Pole Creek

Landowner: US Forest Service
 Sec Twship Range: Section 4, T27N, R17E
 Lat and Long: 47 Deg 52' 15.84"N, 120 Deg 43' 19.11" W



REV	DATE	BY	APPD	DESCRIPTION

SCALE VERIFICATION

BAR IS ONE INCH ON ORIGINAL DRAWING. 0 1"

IF NOT ONE INCH ON THIS SHEET, ADJUST SCALES ACCORDINGLY.

DESIGN BY:
Waterfall Engineering

DRAWN BY:

DATE:
9/27/22

Legend

2 **8**
SHEET OF

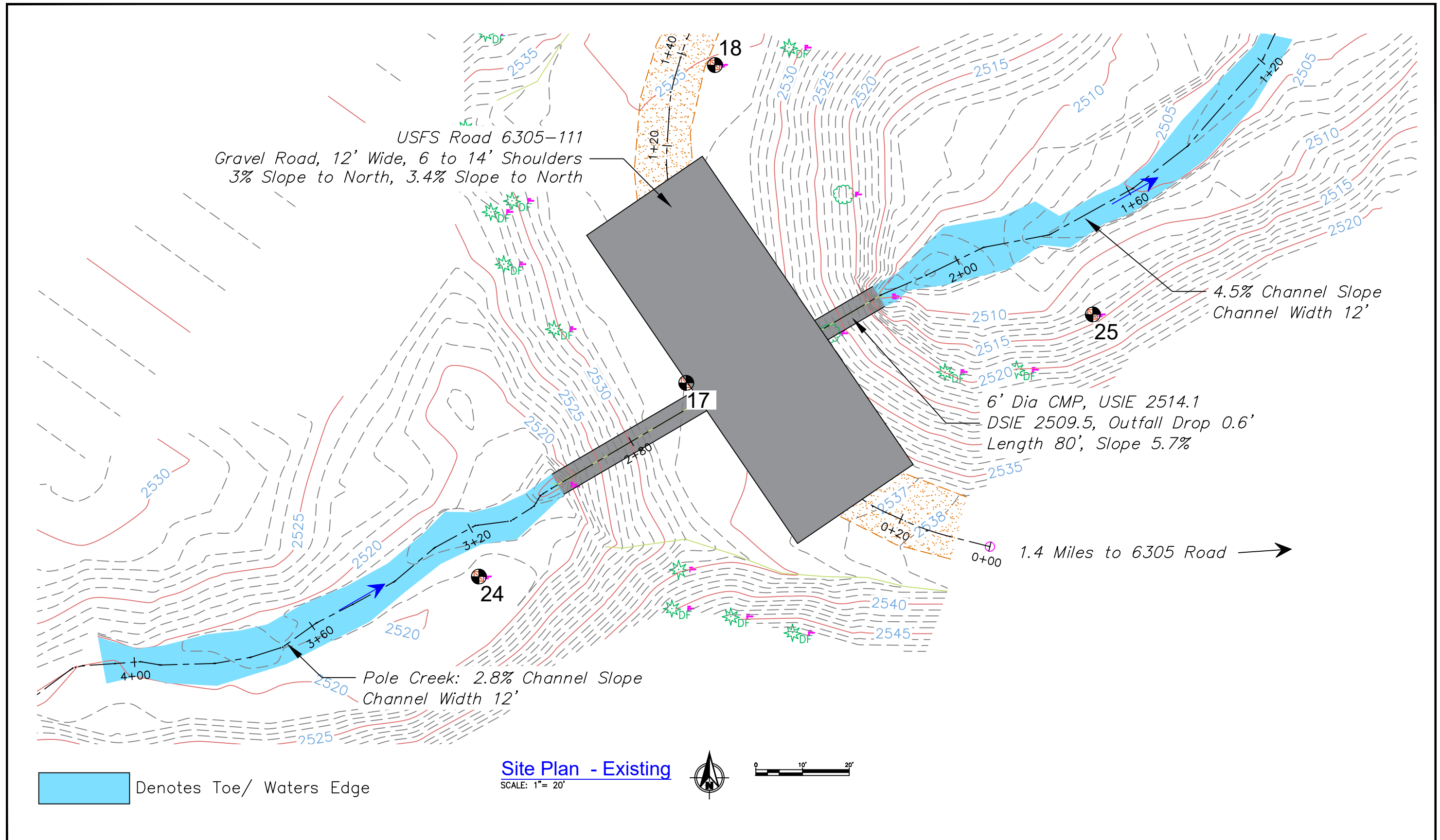

	Pole Creek		<table border="1" style="width: 100%; border-collapse: collapse;"> <thead> <tr> <th>REV</th> <th>DATE</th> <th>BY</th> <th>APPD</th> <th>DESCRIPTION</th> </tr> </thead> <tbody> <tr><td> </td><td> </td><td> </td><td> </td><td> </td></tr> <tr><td> </td><td> </td><td> </td><td> </td><td> </td></tr> <tr><td> </td><td> </td><td> </td><td> </td><td> </td></tr> </tbody> </table>	REV	DATE	BY	APPD	DESCRIPTION																DESIGN BY: Waterfall Engineering DRAWN BY: DATE: 4/10/23	Existing Site Plan	3 8 SHEET OF
	REV		DATE	BY	APPD	DESCRIPTION																				
Landowner: US Forest Service Sec Twship Range: Section 4, T27N, R17E Lat and Long: 47 Deg 52' 15.84"N, 120 Deg 43' 19.11" W	SCALE VERIFICATION <small>BAR IS ONE INCH ON ORIGINAL DRAWING.</small> <small>IF NOT ONE INCH ON THIS SHEET, ADJUST SCALES ACCORDINGLY.</small>																									

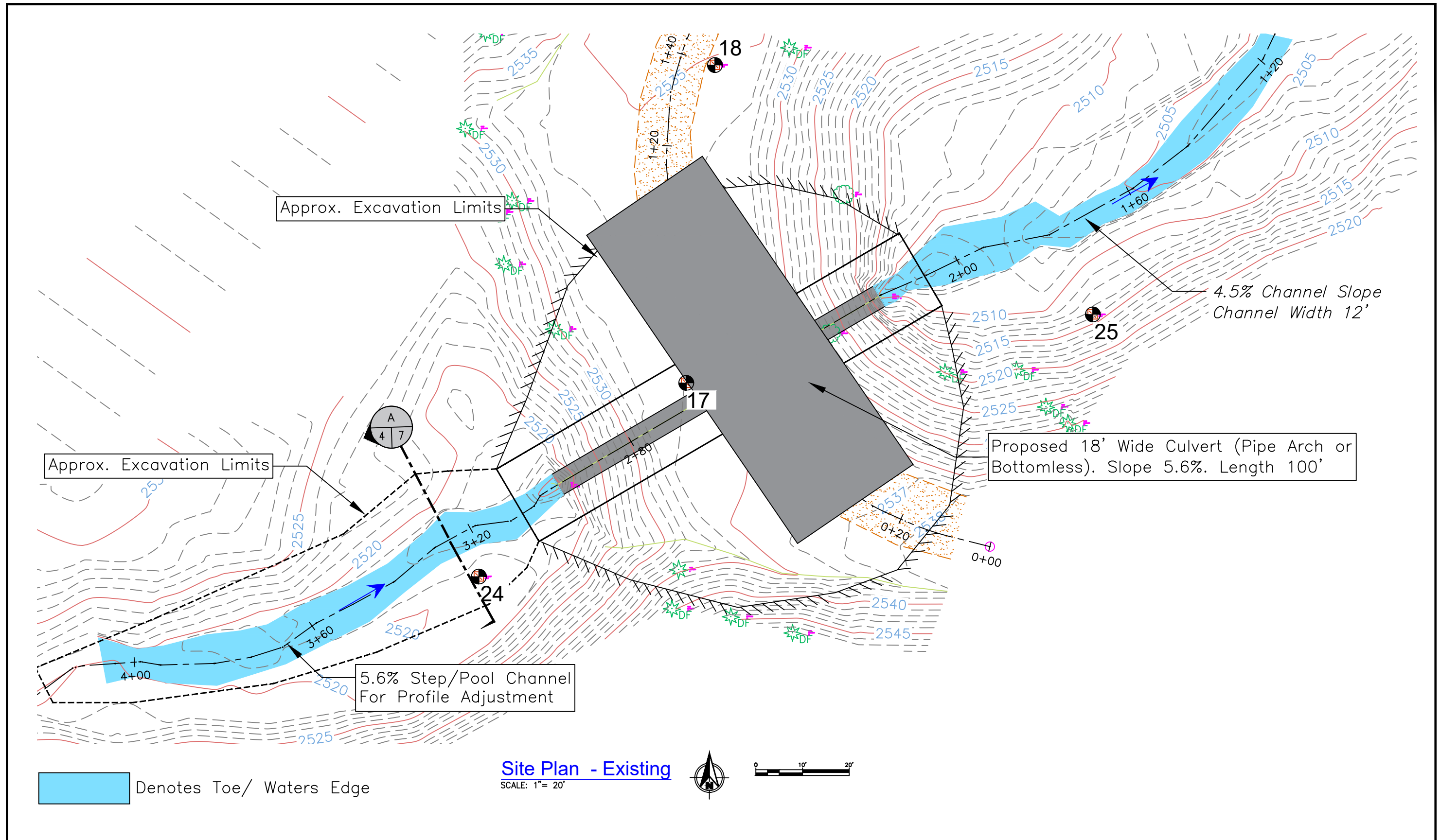

Denotes Toe/ Waters Edge

Site Plan - Existing
SCALE: 1" = 20'

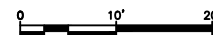

	Pole Creek		<table border="1" style="width: 100%; border-collapse: collapse;"> <thead> <tr> <th>REV</th> <th>DATE</th> <th>BY</th> <th>APPD</th> <th>DESCRIPTION</th> </tr> </thead> <tbody> <tr> <td> </td> <td> </td> <td> </td> <td> </td> <td> </td> </tr> </tbody> </table>	REV	DATE	BY	APPD	DESCRIPTION						DESIGN BY: Waterfall Engineering DRAWN BY: DATE: 9/27/22	Proposed Site Plan	4 8 SHEET OF
	REV		DATE	BY	APPD	DESCRIPTION										
Landowner: US Forest Service Sec Twship Range: Section 4, T27N, R17E Lat and Long: 47 Deg 52' 15.84"N, 120 Deg 43' 19.11" W	SCALE VERIFICATION <small>BAR IS ONE INCH ON ORIGINAL DRAWING.</small> <small>IF NOT ONE INCH ON THIS SHEET, ADJUST SCALES ACCORDINGLY.</small>															

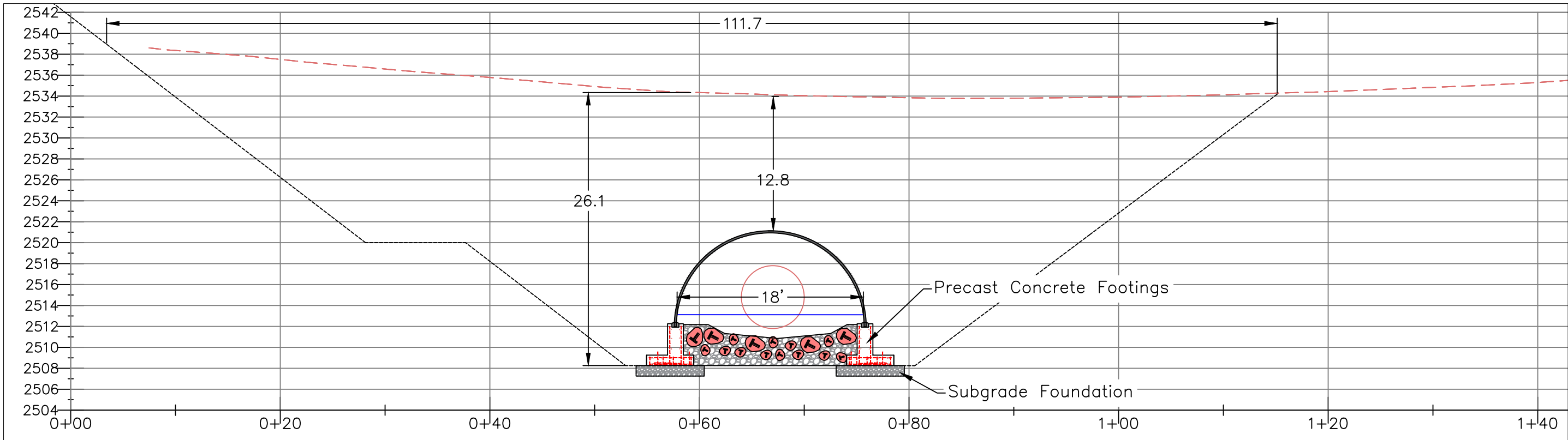

Road Section - View Upstream

Scale: 1" = 10'



Pole Creek

Landowner: US Forest Service
 Sec Twnshp Range: Section 4, T27N, R17E
 Lat and Long: 47 Deg 52' 15.84"N, 120 Deg 43' 19.11" W



REV	DATE	BY	APPD	DESCRIPTION

SCALE VERIFICATION
 BAR IS ONE INCH ON ORIGINAL DRAWING. 0 1"
 IF NOT ONE INCH ON THIS SHEET, ADJUST SCALES ACCORDINGLY.

DESIGN BY:
Waterfall Engineering
 DRAWN BY:

 DATE:
4/10/23

Road Profile

5 **8**
 SHEET OF

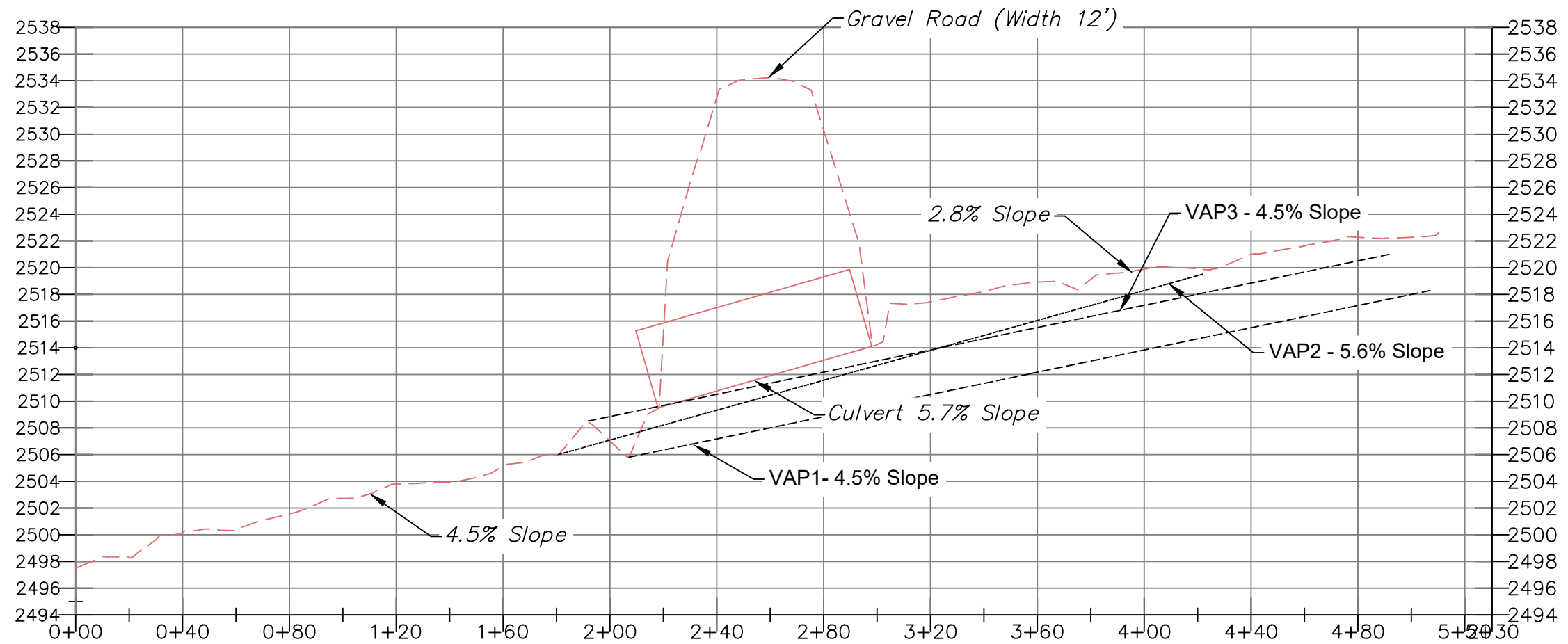

Existing "Long" Stream Profile

Scale: Vertical 1" = 10', Horizontal 1" = 50'

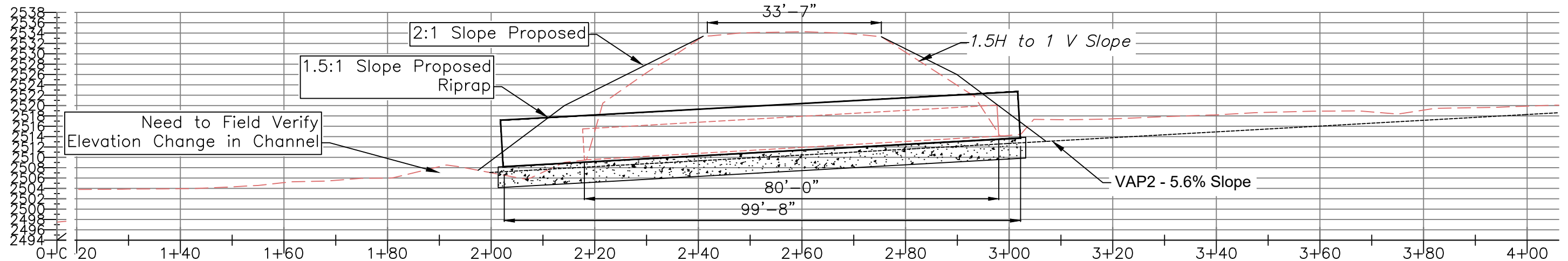

Existing Stream Profile

Scale: 1" = 20'



Pole Creek

Landowner: US Forest Service
 Sec Twship Range: Section 4, T27N, R17E
 Lat and Long: 47 Deg 52' 15.84"N, 120 Deg 43' 19.11" W



REV	DATE	BY	APPD	DESCRIPTION

SCALE VERIFICATION: BAR IS ONE INCH ON ORIGINAL DRAWING. 0 1"

IF NOT ONE INCH ON THIS SHEET, ADJUST SCALES ACCORDINGLY.

DESIGN BY:
Waterfall Engineering

DRAWN BY:

DATE:
4/10/23

Stream Profile

6 **8**
SHEET OF

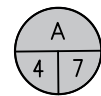
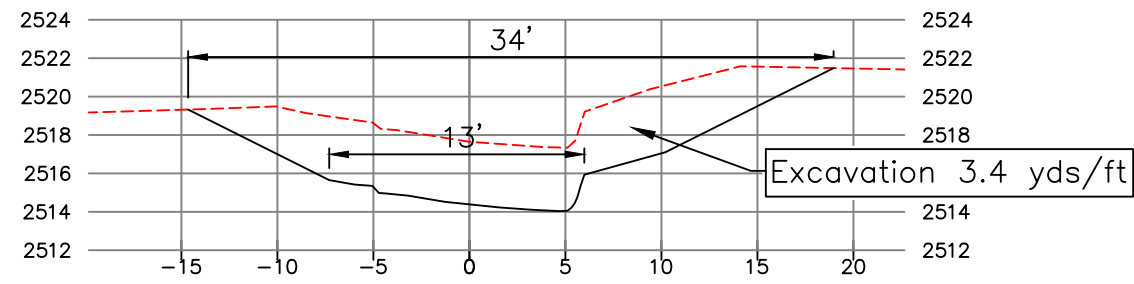

Stream Section - View Upstream - STA 3+25

SCALE: 1" = 10'



Pole Creek

Landowner: US Forest Service
 Sec Twnshp Range: Section 4, T27N, R17E
 Lat and Long: 47 Deg 52' 15.84"N, 120 Deg 43' 19.11" W

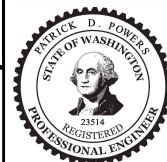

REV	DATE	BY	APPD	DESCRIPTION

SCALE VERIFICATION
 BAR IS ONE INCH ON ORIGINAL DRAWING. 0 1"
 IF NOT ONE INCH ON THIS SHEET, ADJUST SCALES ACCORDINGLY.

DESIGN BY:
Waterfall Engineering

DRAWN BY:

DATE:
9/27/22

Sections

7 **8**
SHEET OF

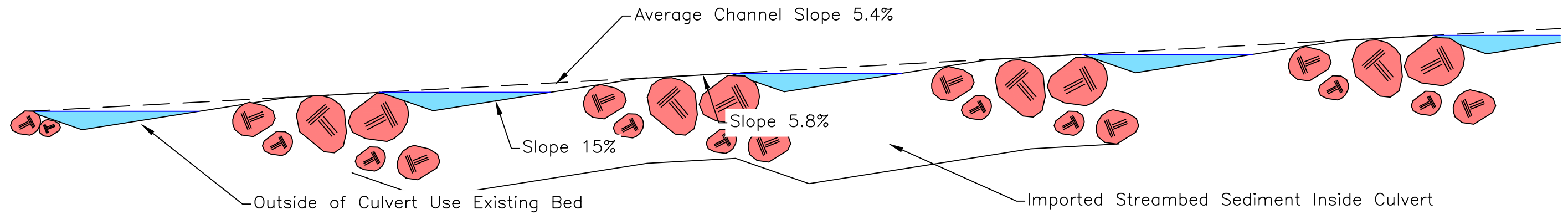

Typical Stream Profile

Scale: 1" = 5'

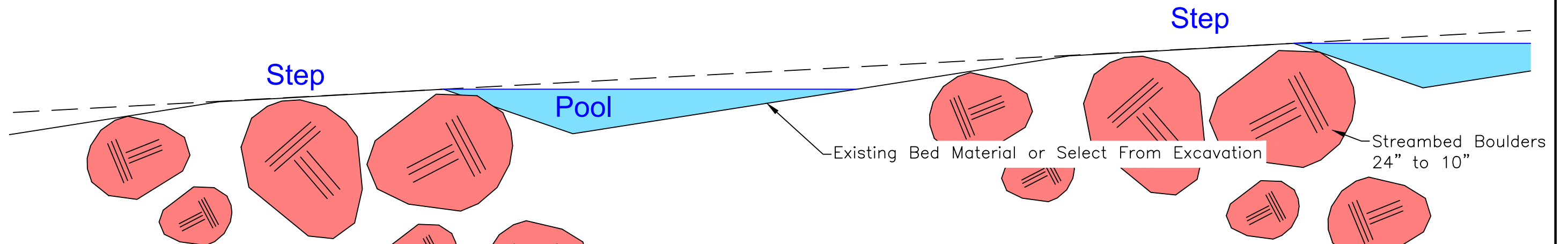

Step/Pool Profile Detail

Scale: 1" = 2'



Pole Creek

Landowner: US Forest Service
 Sec Twnshp Range: Section 4, T27N, R17E
 Lat and Long: 47 Deg 52' 15.84"N, 120 Deg 43' 19.11" W



REV	DATE	BY	APPD	DESCRIPTION

SCALE VERIFICATION

BAR IS ONE INCH ON ORIGINAL DRAWING. 0 1"

IF NOT ONE INCH ON THIS SHEET, ADJUST SCALES ACCORDINGLY.

DESIGN BY:
Waterfall Engineering

DRAWN BY:

DATE:
4/12/23

Details

8 8
SHEET OF